

The *Agnews* Premier Collection



Superior quality cast-iron fireplaces for the home



Introduction

There can be little more inviting, or comforting, than the warmth and welcoming glow of a traditional cast-iron fireplace. Part of our cultural heritage, the beautiful cast-iron fireplace combined practical robustness with style and fashion, becoming the focal point of our room. These fires also provided the warmth needed during the cold winters of the last few centuries, burning natural coals supplied in abundance by the numerous mines up and down the country.

Today, due to environmental concerns, natural coal fires have been greatly restricted in our towns and cities, but the resilient cast-iron fireplace has remained with us, still capable of using solid fuel, but also having the option of using cleaner gas fire engines or efficient electric alternatives.

The Agnews Premier Collection is a comprehensive range of superior quality cast iron fireplaces, the culmination of over 25 years experience in the casting and polishing processes, with the addition of an unique application called Duracote, which seals in the shine of a full or half polished surface ensuring that, with only the minimum upkeep, it will retain a superb finish and last for many years.

Take your time to enjoy this range of quality castings and admire the beautiful mantelpieces available in natural materials such as marble, granite, limestone, antiqued pine and traditional oak. Choose between a real solid fuel fireplace, a realistic gas coal effect option, an Integra high output & efficient gas fire alternative (page 22) or a remote controlled Electric inset fire. (page 22).

Whether your taste is for the timeless splendour of a traditional fireplace, or the more minimalist contemporary design, the Agnews Premier Collection will have something for you.

Contents

	Page
Anson <i>Half Polish</i>	3
Ardley	4
Anson <i>Full Polish</i>	5
Majestic Arch	6
Camden	7
Ashbourne	8
Arklow	9
Westminster Hob	10
Washington <i>Half Polish</i>	11
Aston	12
Atticus Plate	13
Art Nouveau	14
Belfast	15
Belmont	16
Roma	17
Oxford	18
Liberty	19
Ashfield	20
Tiles and Sleeves	21
Integra and Electric Options	22
Specifications	23

Cast-Iron Care

PACKAGING

Your Agnews cast-iron fireplace is packaged so as to minimise exposure to adverse elements and should reach you in perfect condition. The product should be stored in a warm, dry environment and remain packaged until the fireplace is ready to be installed. This will prevent accidental damage being caused, which will not be covered under warranty. It is essential that you inspect your Agnews casting prior to installation as it will be deemed to be of merchantable quality thereafter and no liability will be accepted for product removal, reinstallation or redecoration.

CLEANING

Your Agnews casting requires only the minimum upkeep and it should remain in superb condition for many years. Matt black, Antique, Highlight or polished Duracote finishes can be maintained simply by dusting with a dedicated dry paint brush.

It is normal for some discolouration to occur to the working parts of a cast-iron fireplace. If discolouration is likely to cause some distress, especially if solid fuel is being used, use a black or antique (graphite) finish and remember that cast-iron is robust and can always be refurbished when not in use.

Graphite is liable to leave marks on fingers etc. where contact is made and will need to be cleaned off. Matt black cast-iron paint, grate polish (graphite finishes) or metal polish (polished finishes) can be applied to your cast-iron fireplace but only in exceptional circumstances following expert advice – see page 21 for polishes and after-care..

WARNING

Cast-iron products are vulnerable to rust and tarnishing if exposed to dampness or water. Avoid contact with damp cloths, wet plaster, wallpaper steamers, water-based liquids, furniture polish, etc. to the surface of the cast-iron. Should your fireplace become wet for any reason, dab it gently with a simple dry cloth. This should prevent any tarnishing or rust from forming.

Anson *Half Polish*



The Anson is a plain arched insert with a contemporary feel and is shown here in Half Polish Duracote, the matt black outer band contrasting with the off white colour of the William IV mantel in Italian Carrara.

The Anson is also available in a more discreet Matt Black Finish.

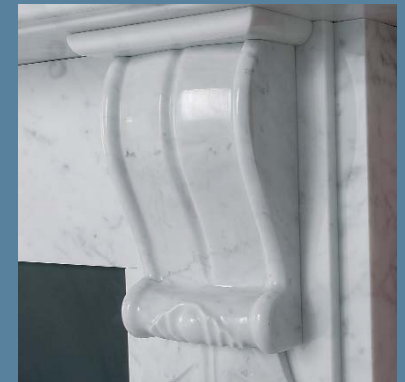

Cast	Anson <i>Half Polish Duracote</i>
Mantel	William IV Carrara Marble
Fire-Back	Attached (Deep SF Back Option)
Hearth	Granite 57" x 17"
Gas	Cast Tec Arch (<i>input 6.9kW</i>)
Solid Fuel	SF Kit A
Electric	Electric Arch
Integra Options	Yes – see page 22 and Integra Collection brochure

Ardley

The Ardley is a traditional arched insert with an intricate decorative band giving an understated appearance even in a Highlight Polished Finish as shown. Also available in a Matt Black or Antique Finishes the Ardley is shown inside the Verona marble mantel in Italian Carrara.

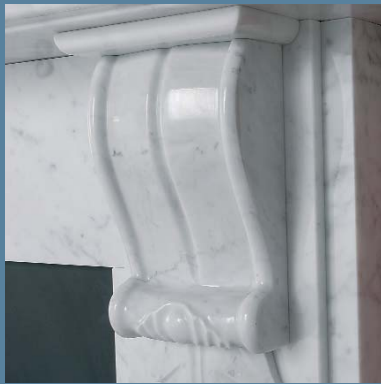

Optional canopy available



Cast	Ardley <i>Highlight Polished</i>
Mantel	Verona Carrara Marble
Fire-Back	Attached (Deep SF Back Option)
Hearth	Granite 57" x 17"
Gas	Cast Tec Arch (<i>input 6.9kW</i>)
Solid Fuel	SF Kit A
Electric	Electric Arch

Anson *Full Polish*



The Anson is the jewel in the crown of the arched inserts and is shown here in a stunning Full Polish Duracote Finish, a stark contrast to the black granite of the Athena mantel.



Optional canopy available

Cast	Anson <i>Full Polish Duracote</i>
Mantel	Athena Black Granite
Fire-Back	Attached (Deep SF Back Option)
Hearth	Granite 57" x 17"
Gas	Cast Tec Arch (<i>input 6.9kW</i>)
Solid Fuel	SF Kit A
Electric	Electric Arch
Integra Options	Yes – see page 22 and Integra Collection brochure

Majestic Arch

The Majestic Arch is an arched insert with a minimalist feel sporting a simple polished Duracote arched band against a matt black background. Shown here inside the Flat Victorian mantel in natural Aegean Limestone the Majestic Arch would grace contemporary or traditional room settings.



Cast	Majestic Arch <i>Polished Duracote</i>
Mantel	Flat Victorian Aegean Limestone
Fire-Back	Attached (Deep SF Back Option)
Hearth	Granite 54" x 15"
Gas	Cast Tec Arch (input 6.9kW)
Solid Fuel	SF Kit A
Electric	Electric Arch
Integra Options	Yes – see page 22 and Integra Collection brochure

Camden



The Camden has been reproduced from an original design and being the largest of the arched inserts is ideally suited to the larger traditional mantels. Available in a Highlight Polish (shown), Matt Black or Antique Finish the Camden is shown inside the William IV mantel in Carrara Italian Marble.

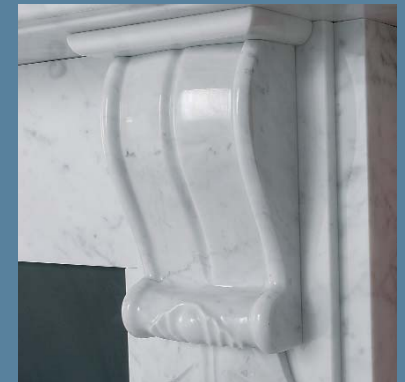

Cast	Camden <i>Highlight Polished</i>
Mantel	William IV Carrara Marble
Fire-Back	Attached
Hearth	Granite 57" x 17"
Gas	Camden Arch (<i>requires ventilation</i>)
Solid Fuel	SF Kit D

Ashbourne

The Ashbourne is a decorative arched insert shown here in an Antique Finish inside the Corbel mantel in solid pine. Also available in Matt Black or Highlight Polish (see inset) the Ashbourne has the option of a plain or decorative Ashcover and Canopy as shown.



Cast	Ashbourne <i>Antique Finish</i>
Mantel	Corbel Pine (also available in Oak)
Fire-Back	Attached
Hearth	Granite 54" x 15"
Gas	Cast Tec Arch (<i>input 6.9kW</i>)
Solid Fuel	SF Kit C
Electric	Electric Arch
Integra Options	Yes – see page 22 and Integra Collection brochure

Arklow



The Arklow is a highly ornate arched insert reproduced from an original design. The superb definition is shown in Highlight Polish to the fascia and uniquely to the fire-back as well. Shown inside the Flat Victorian mantel in Aegean Limestone the Arklow is also available in a Matt Black or Antique Finish.

Cast	Arklow <i>Highlight Polished</i>
Mantel	Flat Victorian Aegean Limestone
Fire-Back	Attached
Hearth	Granite 57" x 17"
Gas	Arklow Arch (<i>input 6.9kW</i>)
Solid Fuel	SF Kit K

Westminster Hob

The Westminster is a reproduction of an original hob grate and is shown here in a Highlight Polish Finish. Two small shelves inside the left and right-hand sides of the fire opening were used in days gone by to heat flat-irons and kettles. Also available in a Matt Black or Antique Finish the Westminster is shown inside the Georgian mantel in solid pine.



Cast	Westminster Hob <i>Highlight Polished</i>
Mantel	Georgian Pine (also available in Oak)
Fire-Back	Attached
Hearth	Granite 54" x 15"
Gas	Westminster Arch (<i>requires ventilation</i>)
Solid Fuel	SF Kit W

Washington *Half Polish*



The Washington is an unique contemporary square insert with a small canopy shown here in Half-Polish Duracote. Also available in a Matt Black or Antique Finish the Washington is shown inside the Flat Victorian mantel in Carrara Italian Marble.

Cast	Washington <i>Half Polish Duracote</i>
Mantel	Flat Victorian Carrara Marble
Fire-Back	Optional
Hearth	Granite 57" x 17"
Gas	Cast Tec 16 (<i>input 6.9kW</i>)
Solid Fuel	SF Kit U
Electric	Electric 16
Integra Options	Yes – see page 22 and Integra Collection brochure

Aston

The Aston is a traditional Victorian tiled insert shown here in an Antique (graphite) Finish. Also available in Highlight Polish or Matt Black the Aston is shown inside the Sherwood mantel in solid pine (also available in solid Oak). A choice of tiles or sleeves are available on page 21.



Cast	Aston <i>Antique Finish</i>
Mantel	Sherwood Pine (also available in Oak)
Fire-Back	Optional
Hearth	Granite 54" x 15"
Tiles	Oriental Iris <i>Ivory/Burgundy</i>
Gas	Cast Tec 16 (<i>input 6.9kW</i>)
Solid Fuel	SF Kit U
Electric	Electric 16
Integra Options	Yes – see page 22 and Integra Collection brochure

Atticus Plate



The Atticus is a contemporary cast-iron plate with a traditional fireplace opening to accommodate a new or existing gas or electric fire. An optional fire-front suitable for use with solid-fuel is also available (see inset). The Atticus, shown inside the Danbury pine mantel along with an Integra Engine gas fire with chrome embellishments, is available in Full Polish Duracote, Half-Polish Duracote (shown) or Matt Black.

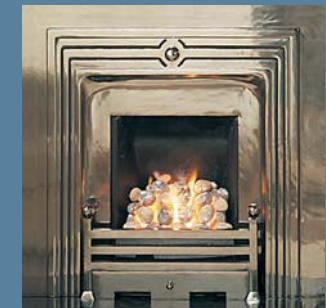

Atticus Full Polish Duracote shown with optional Fire-front.

Cast	Atticus <i>Half Polish Duracote</i>
Mantel	Danbury Pine (also available in Oak)
Cut-Out	419mm x 571mm
Hearth	Granite 54" x 15"
Gas	Yes
Solid Fuel	Yes
Electric	Yes

Art Nouveau

The Art Nouveau is a typical tiled insert dating from the period 1880-1910. Available in Highlight Polish (shown), Matt Black or Antique Finishes the Art Nouveau is displayed inside the Flat Victorian mantel in solid pine (also available in solid Oak). A choice of tiles or sleeves are available on page 21.



Cast	Art Nouveau <i>Highlight Polished</i>
Mantel	Flat Victorian Pine (available in Oak)
Fire-Back	Optional
Hearth	Granite 54" x 15"
Tiles	Mediterranean Poppy <i>Honey/Yellow</i>
Gas	Cast Tec 16 (<i>input 6.9kW</i>)
Solid Fuel	SF Kit U
Electric	Electric 16

Belfast



The Belfast is unique being an arched and tiled insert combined. It's traditional styling and bulky depth makes it the perfect partner to compliment a larger traditional mantel. Shown here inside the Victorian Corbel mantel in Aegean Limestone the Belfast is available in a Highlight Polish, Matt Black or Antique Finish. A choice of tiles or sleeves are available on page 21.

Cast	Belfast <i>Highlight Polished</i>
Mantel	Victorian Corbel Aegean Limestone
Fire-Back	Attached
Hearth	Granite 57" x 17"
Tiles	Mediterranean Poppy <i>Green/Burgundy</i>
Gas	Cast Tec Arch (<i>input 6.9kW</i>)
Solid Fuel	SF Kit B
Electric	Electric Arch

Belmont

The Belmont is an art nouveau style tiled insert shown here in Full Polish Duracote, a stunning contrast to the black granite of the Verona mantel surrounding it. The Belmont is also available in a Matt Black or Antique Finish and a choice of tiles or sleeves to suit it are shown on page 21.



Cast	Belmont <i>Full Polish Duracote</i>
Mantel	Verona Black Granite
Fire-Back	Optional
Hearth	Granite 57" x 17"
Tiles	Mediterranean Poppy <i>Ivory/Burgundy</i>
Gas	Cast Tec 16 (<i>input 6.9kW</i>)
Solid Fuel	SF Kit U
Electric	Electric 16

Roma



The Roma is an Edwardian style tiled insert shown here in Full Polish Duracote giving it a striking contemporary feel. Shown inside the Flat Victorian mantel in black granite the Roma is also available in a Matt Black or Antique Finish. For a more minimalist look a plain version of the Roma called the Jesmond (see inset) is available. A choice of tiles or sleeves are available on page 21.



Jesmond Full Polish Duracote with Art Deco Sleeves

Cast	Roma <i>Full Polish Duracote</i>
Mantel	Flat Victorian Black Granite
Fire-Back	Optional
Hearth	Granite 57" x 17"
Tiles	Liberty <i>Ivory/Blue</i>
Gas	Cast Tec 16 (<i>input 6.9kW</i>)
Solid Fuel	SF Kit U
Electric	Electric 16
Integra Options	Yes (Roma & Jesmond) - see page 22 and Integra Collection brochure

Oxford

The Oxford is a traditional tiled insert depicting an art nouveau tulip design on the canopy. Available in Highlight Polish (shown), Matt Black or Antique Finishes the Oxford is displayed inside the Balmoral mantel in solid pine (also available in solid Oak). A choice of tiles or sleeves are available on page 21.



Cast	Oxford <i>Highlight Polished</i>
Mantel	Balmoral Pine (also available in Oak)
Fire-Back	Optional
Hearth	Granite 54" x 15"
Tiles	Tulip <i>Ivory/Burgundy</i>
Gas	Cast Tec 16 (<i>input 6.9kW</i>)
Solid Fuel	SF Kit U
Electric	Electric 16
Integra Options	Yes – see page 22 and Integra Collection brochure

Liberty



The Liberty is an art nouveau combination casting with a small cast-iron shelf attached. Reproduced from an original bedroom design the Liberty is shown in a striking Full Polish Duracote Finish but is also available in Matt Black or Antique (graphite).

Cast	Liberty <i>Full Polish Duracote</i>
Mantel	Attached
Fire-Back	Optional
Hearth	Granite 42" x 15"
Gas	Cast Tec 16 (<i>input 6.9kW</i>)
Solid Fuel	SF Kit U
Electric	Electric 16

Ashfield

The Ashfield is a traditional combination casting with a small cast-iron shelf attached. Reproduced from an original bedroom design the Ashfield is available in a Highlight Polish, Matt Black or Antique Finish all of which are shown on this page. The Marsden combination (see inset below) is plainer and slightly smaller in size.



Marsden Highlight Polished



Ashfield Matt Black



Ashfield Antique

Cast	Ashfield <i>Combination</i>
Mantel	Attached
Fire-Back	Optional
Hearth	Granite 42" x 15"
Gas	Cast Tec 16 (<i>input 6.9kW</i>)
Solid Fuel	SF Kit U
Electric	Electric 16

Hand Painted Tubeline Tiles

Tubeline Tiles were traditionally made to withstand the high temperatures generated by a working fireplace and performed the practical function of reflecting heat into the room when placed at an angle facing inward.

With a choice of five designs and various colour options, two runs of five tiles make up a set to fit into an Agnews casting. The Luscia and Mediterranean Poppy tile sets include a left and right handed design. Our tubeline tiles are individually handpainted in the traditional way and will be subject to colour variation and normal crazing.

Liberty



Brown Yellow Ivory Blue Green Burgundy Honey Yellow Ivory Burgundy

Oriental Iris

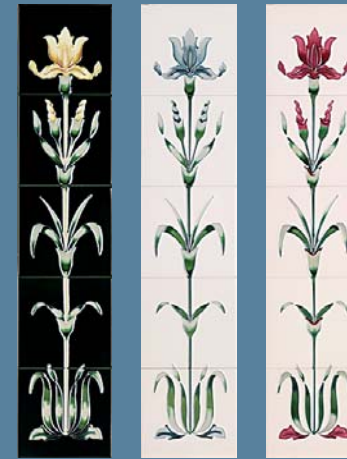

Green Yellow Ivory Blue Ivory Burgundy

Luscia



Honey Yellow Ivory Blue Ivory Burgundy

Mediterranean Poppy



Honey Yellow Ivory Burgundy Green Burgundy Ivory Blue

Tulip

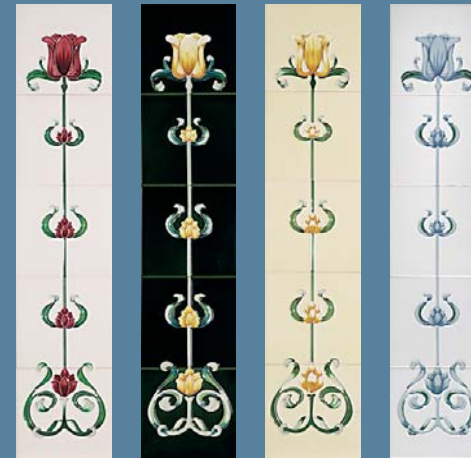

Ivory Burgundy Green Yellow Honey Yellow Ivory Blue

Cast-Iron Sleeves



Lily Man and Woman Victorian Urn



Med Poppy Tulip Bird Daisy

Accessories Matt black cast-iron paint, grate polish (antique finish) or metal polish (polished finishes) can be applied to your cast-iron fireplace but only in exceptional circumstances following expert advice and by using the utmost care.



Grate polish, metal polish & matt black paint

Cast-Iron Sleeves are an alternative to the more colourful tubeline tiles. Two sleeves make up a set to suit an Agnews casting. The Bird sleeves and Man & Woman sleeves include a left and right handed design. Cast-iron sleeves are available in matt black, antique or highlight polished finishes.

Integra Options

High Output, High Efficiency Multiflue Gas Fires

Most gas fires fitted into cast-iron fireplaces are decorative only and don't offer much in the way of warmth and efficiency. The Integra is a range of unique cast-iron fireplaces manufactured specifically to suit a high output, high efficiency multiflue gas fire called an Integra Engine. Many of the castings shown in this brochure have an Integra version. Ask your retailer for a copy of the full Integra Collection brochure.

What Integra Engine options do I have?

Class 1 Flues

For rooms with a traditional chimney, there is a deep Convector Engine with an amazing heat output of 4.0kW and an efficiency approaching 60%. There is a choice of manual control or hand held remote control.

Class 2 Flues

For rooms with a flue but no traditional chimney breast there is a Slimline Multiflue Engine with a heat output of 3.3kW and an efficiency approaching 50%. These flues often consist of a pre-cast fluepipe built inside the cavity of a wall and can often be seen from outside by a metal cowl or raised ridge tile on a roof instead of a traditional chimney pot.

No Chimney Options

For rooms with no chimney or flue but a suitable external wall there is Powerflue Engine available with a heat output of 3.3kW and an efficiency approaching 50%.



Integra Split Fascia View

Integra Assembly

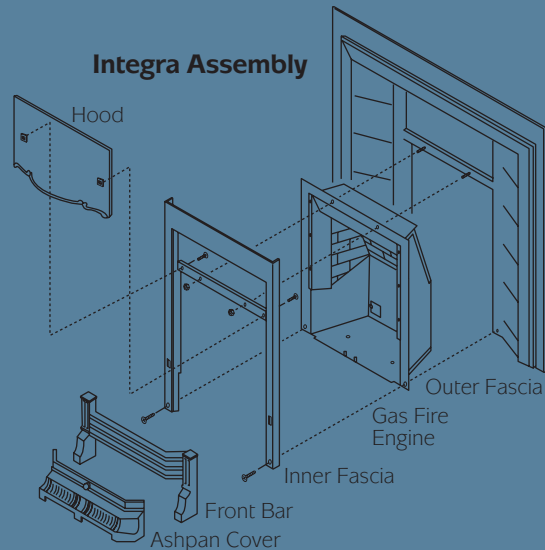

Electric Options

There are two electric fires manufactured specifically to suit the majority of castings in the Agnews Premier Collection. These electric fires are a far cry from the days when it was acceptable to have a fibre-glass mould with a red light bulb inside and a couple of spinners. The other disadvantage in those days was that the Ashpan Cover had to be removed to allow the heat from the fan unit out into the room.



Electric 16



Electric Arch

The Cast Tec **Electric 16** (supplied with Damper for use with Universal Cast Back) & Cast Tec **Electric Arch** offer the following unique points:

- **Top Venting** (so that Ashpan Cover can stay in position)
- **Two Heat Settings** (900W & 1800W)
- **Remote Control** (multiple flame settings)
- **LED Effect** (No bulbs to change)
- **Adjustable Height**

OPTIONAL BACKS



Universal Cast Back



Fibre Back



Deep Cast Back

Specifications

Due to the casting process measurements are approximate and may vary

Castings	Fascia Sizes		Inner Band Sizes			Chamber Sizes		
	A <i>Width</i>	B <i>Height</i>	C <i>Width</i>	D <i>Height</i>	E <i>Rebate</i>	F <i>Width</i>	G <i>Height</i>	H <i>Depth</i>
Anson	953	953	800	820	10	686	762	210
Ardley	953	953	813	813	10	686	762	210
Arklow	950	950	788	826	10	813	839	210
Art Nouveau	956	959	864	870	75	See Optional Backs		
Ashbourne	953	953	769	820	10	660	788	191
Ashfield	953	966	832	n/a	Flush	See Optional Backs		
Aston	956	959	864	870	75	See Optional Backs		
Atticus Plate	959	959	839	813	10	See Optional Backs		
Belfast	966	959	845	864	10	839	896	280
Belmont	956	959	864	870	75	See Optional Backs		
Camden	1016	972	902	896	10	870	928	286
Jesmond	959	959	880	883	75	See Optional Backs		
Liberty	1118	1074	902	n/a	Flush	See Optional Backs		
Majestic	953	953	762	800	10	686	762	210
Marsden	858	965	689	n/a	Flush	See Optional Backs		
Oxford	956	959	870	870	75	See Optional Backs		
Roma	959	959	880	883	75	See Optional Backs		
Westminster	1010	997	832	851	10	826	990	229
Washington	1010	972	807	867	75	See Optional Backs		

maximum mantel openings minimum mantel openings

Mantels		A <i>Shelf Length</i>	B <i>Height</i>	C <i>Int Width</i>	D <i>Int Height</i>	E <i>Base</i>	F <i>Shelf Width</i>	G <i>Rebate</i>
Wood Mantels	Balmoral	1372	1134	915	915	1235	213	25/75
	Corbel	1400	1155	915	915	1330	213	25/75
	Danbury	1370	1220	915	915	1205	200	25/75
	Georgian	1400	1115	915	915	1225	200	25/75
	Sherwood	1372	1175	915	915	1283	219	25/75
	Flat Victorian	1448	1150	915	915	1327	200	25/75
Stone Mantels	Athena	1524	1150	915	915	1425	260	75
	Flat Victorian	1470	1145	915	915	1355	205	75
	Verona	1512	1150	915	915	1425	248	75
	Victorian Corbel	1524	1194	915	915	1347	279	75
	William IV	1512	1150	915	915	1425	248	75

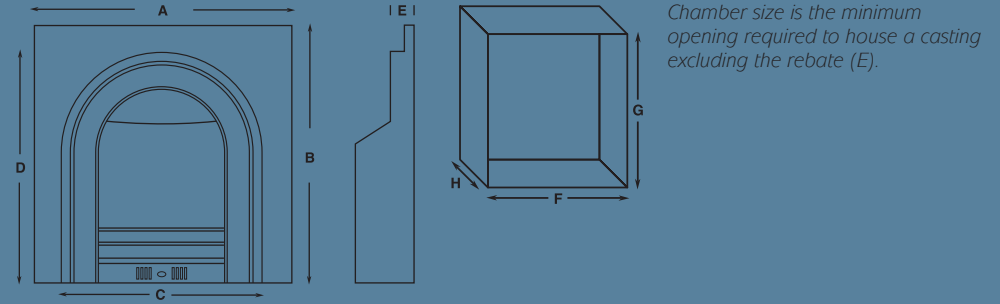

Chamber size is the minimum opening required to house a casting excluding the rebate (E).

Optional Backs	F <i>Width</i>	G <i>Height</i>	H <i>Depth</i>
Universal Cast Back <i>suits gas, electric and solid fuel</i>	432	623	191
Fibre Back <i>gas only, increases output 1kW</i>	445	585	204
Deep Cast Back <i>solid fuel for Anson/Ardley/Majestic</i>	496	629	245

Important Information

Products shown in this brochure are manufactured for Cast Tec Ltd. who, with a professional group of companies, distribute them exclusively in the UK.

Goods must be checked prior to installation, as no responsibility will be accepted thereafter for the redecoration, removal or reinstallation of products. Faulted goods must be reported within 48 hours.

Installation should be carried out by a qualified professional fireplace fitter. No responsibility will be accepted for damage or problems arising from an incorrect or unqualified installation.

When burning solid fuel, a new cast-iron fireplace must be tempered by burning five small fires of no more than 3kg of fuel. This procedure will ensure that heat damage through consistent use of the product will be minimised. Caution must be taken with petroleum based solid fuels as the heat intensity can cause damage to consumable products such as the fire-brick, bottom grate and ashpan.

Integra is a registered trademark and the Integra Split Fascia Concept is patented.

Cast Tec Arches & 16s are CE approved and manufactured specifically to suit the Agnews Collection range of castings. No responsibility will be accepted for problems arising where a gas appliance has been used which is not approved or suitable to fit into an Agnews casting or where the fitting has

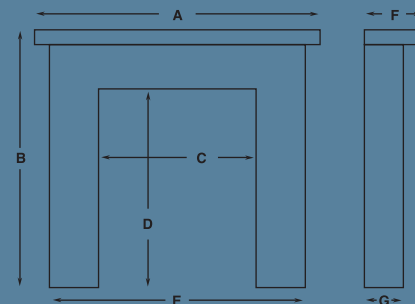

taken place without the relevant instructions. It is normal for carbon deposits to appear on top of the ceramic coals of a gas fire, these can be brushed away with a soft brush when the fire is not in use.

Cast Tec Ltd. reserve the right to delay or withdraw products, change designs, specifications or materials without prior notice due to continuous product development or supply problems.

Photographs and designs shown in this brochure are the copyright and design rights of Cast Tec Ltd. and can only be used or copied with permission.

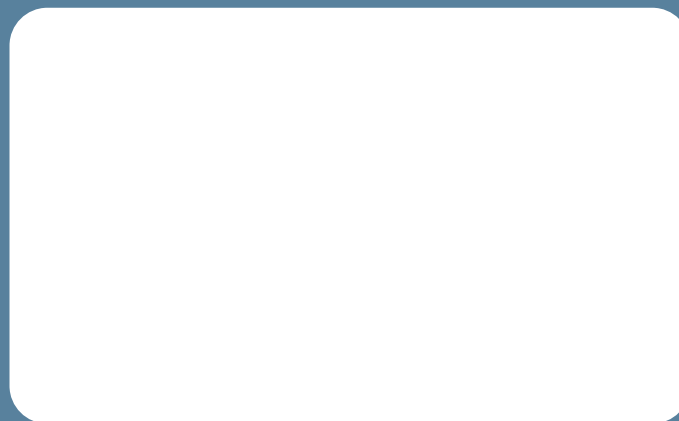

Dealer Stamp

