



Integra Collection

Efficient cast iron fireplaces for every home

Gas and Electric Options

Contents

Integra Castings

- 3 Washington
- 4 Eden
- 5 Anson Full Polish
- 6 Oxford
- 7 Ashbourne
- 8 Anson Black
- 9 Jesmond
- 10 Anson Half Polish
- 11 Aston
- 12 Glen
- 13 Majestic
- 14 Assembly Details
& Dimensions
- 15 Tiles & Sleeves

Gas Fires with Trims & Frets

- 16 Multiflue
- 17 Convector
- 18 Powerflue
- 19 Gas Fire Specifications

There can be little else more inviting and comforting than the warmth and glow of a real coal fire inside a traditional cast-iron fireplace. The Industrial Revolution launched the robust, practical yet stylish cast-iron fireplace and it still remains with us today. The use of an open coal fire, however, having declined in our towns and cities due to environmental concerns, has been replaced by the cleaner and more convenient gas fire. These gas fires succeeded in looking very realistic but gave out precious little in the way of heat with an efficiency of around 25% (75% of the heat going straight up the chimney).

What options do we have to look forward to in today's greener fireplace market? Well, how about integrating a range of quality cast-iron fireplaces (let's call it the Integra) together with an open, efficient and high output gas fire (let's call it an Integra Engine)? Well that concept has now arrived. *Welcome to the **INTEGRA COLLECTION!***

What is so Special about the Integra Collection?

Most gas fires supplied with a cast-iron fireplace tend to be decorative only but don't offer much in the way of heat and efficiency with 75% of the heat being lost up the chimney. The Integra Collection boasts a realistic, efficient and high output gas fire with a choice of cast-iron insert providing a unique combination of looks, warmth and savings.

Describe the Gas Fire options that are available?

Traditional Chimneys

For rooms with a traditional chimney (known as a Class 1 Flue), there is a deep Convector Engine with an amazing heat output of 4kW and an efficiency approaching 60%. There is a choice of manual control or hand held remote control.



Pre-cast Flues

For rooms with a flue but no traditional chimney breast there is a Multiflue Engine with a heat output of 3.3kW and an efficiency approaching 50%. These flues often consist of a pre-cast fluepipe built inside the cavity of a wall and can often be seen from outside by a metal cowl or raised ridge tile on a roof instead of a traditional chimney pot.

No Chimney Options

For rooms with no chimney or flue but a suitable external wall there is Powerflue Engine available with a heat output of 3.3kW and an efficiency approaching 50%.

Is there an Electric option available?

Yes, there is an electric fire available to suit all Integra castings. See page 12 for details.

Is there a Solid Fuel option available?

Integra is not suitable for solid fuel but there is a range of similar castings called the Agnews Collection which are manufactured in the traditional way and suitable for solid fuel. For more information please ask your retailer for a **brochure**, email info@casttec.co.uk or view the website www.agnewsfireplaces.co.uk.



Is there a choice of Finishes available to the cast-iron inserts?

There are four finishes available: Matt Black, Antique (graphite, similar to the old black lead), Highlight Polish (highlighting of a decorative design with black background) or Polished Duracote (an application which seals in the shine of a fully polished surface).

Are the Mantels shown in the brochure available?

All mantels shown in the brochure are available from your Retailer. Material options include Limestone from Turkey, Pure Marbles from Italy, Black Granite from China and Timber Mantels in Solid Oak or Antiqued Pine.

**FITTER FRIENDLY
CASTINGS**

– see Assembly Details
on page 14.



Washington Integra

Polished

The Washington Integra is a simple square design as opposed to the usual arched design. The casting is shown in a polished Duracote finish and is also available in matt black. The York mantel is suitable for smaller chimney breasts and is shown here in beige Crema Marfil pure marble sitting on a black granite hearth.

Cast	Washington Integra Polished
Mantel	York Crema Marfil 54"
Hearth	Granite 54" x 15"
Gas	Integra Engine

Eden Integra

Antique

The Eden Integra casting is a classic Victorian tiled design shown here in an authentic Antique Finish using black graphite instead of the old black lead. The casting, also available in a Matt Black Finish, is shown here with a set of Mediterranean Poppy ceramic tiles in Ivory & Burgundy accompanied by an antiqued Danbury Solid Pine Mantel (also available in traditional Solid Oak).

Cast	Eden Integra Antique Finish
Mantel	Danbury Solid Pine
Tiles	Mediterranean Poppy Ivory/Burgundy
Hearth	Granite 54" x 15"
Gas	Integra Engine





Anson Integra Full Polish

The Anson is an elegant arched insert shown here in Full Polish Duracote. The stunning polished finish gives a contemporary feel but this can be toned down with the more traditional look of matt black. The Anson is shown with an Athena black granite mantel and black granite hearth.

Cast	Anson Integra Full Polish
Mantel	Athena Black Granite
Hearth	Granite 57" x 17"
Gas	Integra Engine

Oxford Integra

Polished

The Oxford Integra is a typical art nouveau period casting shown here in a highly polished Duracote finish (also available in matt black). The tulip design on the canopy compliments the Liberty tile set displayed in ivory and burgundy. The Oxford is shown inside the Limerick cast-iron mantel in a highlight polished finish sitting on a black granite hearth.

Cast	Oxford Integra Polished
Mantel	Limerick Cast Iron
Tiles	Liberty Ivory/Burgundy
Hearth	Granite 54" x 15"
Gas	Integra Engine





Ashbourne Integra

Polished

The Ashbourne Integra is a traditional decorative arched insert with the intricate detail shown in a highlight polish finish. An equally splendid but more discreet look is achieved using a matt black finish. The Ashbourne is shown inside the Verona marble mantel in Italian Carrara (also available in black granite or Crema Marfil beige marble).



Cast	Ashbourne Integra Polished
Mantel	Verona Carrara Marble
Hearth	Granite 57" x 17"
Gas	Integra Engine

Anson Integra Black

The Anson Integra is a simple arched insert shown here in an understated Matt Black Finish. The simplicity of the casting compliments the bold corbels of the Traditions solid oak Richmond mantel in a period finish (Antiqued pine also available).



Cast	Anson Integra Black
Mantel	Richmond Solid Oak
Hearth	Granite 54" x 15"
Gas	Integra Engine



Jesmond Integra

Full Polish

The Jesmond Integra is shown in fully polished Duracote with a set of fully polished Art Deco cast-iron sleeves. Adorned by the Lindisfarne mantel in solid maple with black granite hearth, this fireplace can grace the most contemporary of room settings.

Jesmond Integra is also available with a decorative tulip design canopy (called the Roma Integra).



Cast	Jesmond Integra Full Polish
Mantel	Lindisfarne Solid Maple
Sleeves	Art Deco Full Polish
Hearth	Granite 54" x 15"
Gas	Integra Engine

Anson Integra Half Polish

The Anson Integra Half Polish is an elegant arched insert with a matt black outer band contrasting with a highly polished Duracote interior. The casting looks quite exquisite with the rather grand Durham mantel in beige Crema Marfil pure marble. The base is a simple black granite hearth.



Cast	Anson Integra Half Polish
Mantel	Durham Crema Marfil
Hearth	Granite 57" x 17"
Gas	Integra Engine





Aston Integra

Antique

What could be more traditional than the Aston Integra casting shown in an Antique finish with a set of Oriental Iris tubeline tiles in ivory and blue? The Aston, also available in matt black or highlight polished finishes, is shown inside the Balmoral antiqued pine mantel (solid oak also available) with black granite hearth.

Cast	Aston Integra Antique Finish
Mantel	Balmoral Solid Pine
Tiles	Oriental Iris Ivory/Blue
Hearth	Granite 54" x 15"
Gas	Integra Engine

Glen Integra

Black

The Glen Integra is a traditional design shown in a matt black finish (but also available in highlight polish). The ceramic tiles depict a tulip design in ivory and burgundy colouring. The Traditions solid oak Keilder mantel in a period finish (also available in antiqued pine) is shown sitting on a black granite hearth. The electric fire displayed inside the Glen Integra has an attractive flame effect with a 2kW fan heater and is suited to all Integra castings in this brochure. The Glen Integra can also be used in conjunction with the usual range of gas fire Integra Engines.

Cast	Glen Integra Black
Mantel	Keilder Oak
Tiles	Tulip Ivory/Burgundy
Hearth	Granite 54" x 15"
Electric	Universal Inset





Majestic Integra

Polished

The Majestic Integra is a plain matt black insert with a simple polished Duracote arched band giving a more discreet and minimalist feel. This casting is shown inside the Flat Victorian Mantel in Aegean Limestone (but also available in Black Granite or Carrara Pure Marble).

Cast	Majestic Integra Polished
Mantel	Flat Victorian Aegean Limestone 58"
Hearth	54" x 15"
Gas	Integra Engine



Assembly Details

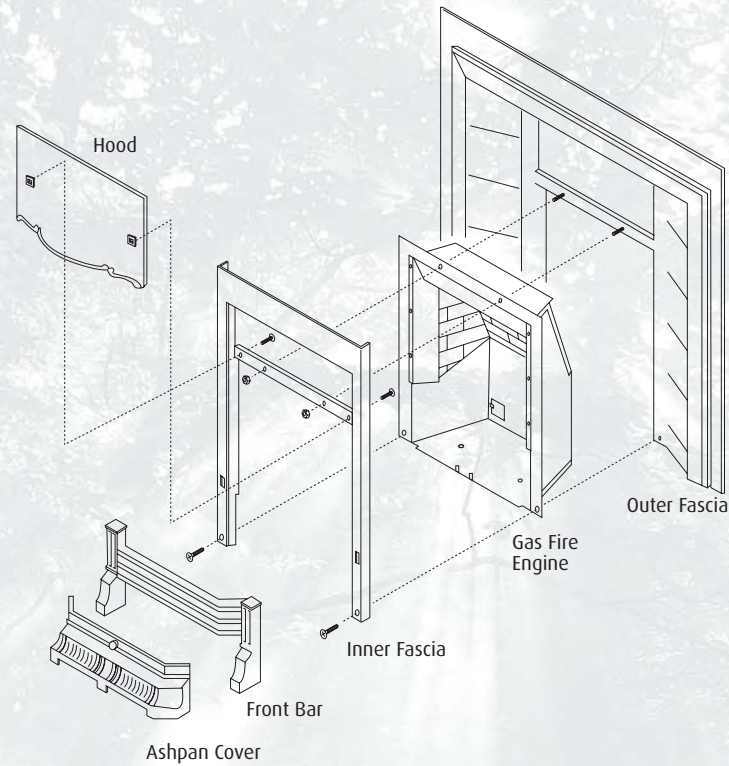

Casting & Mantel Dimensions

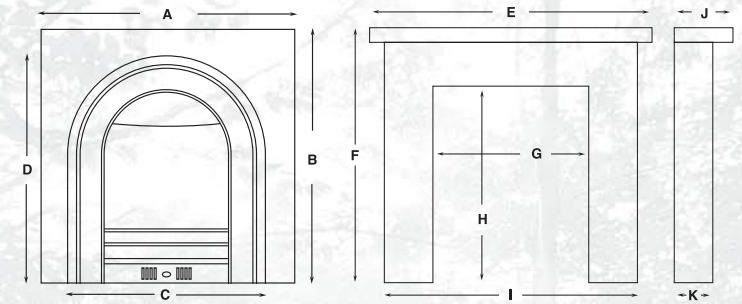

A: width. **B:** height. **C&D:** minimum fire surround aperture required.

Integra Castings	A (width)	B (height)	C	D
Anson	960	960	825	880
Ashbourne	960	960	825	880
Aston	970	960	890	880
Eden	970	960	890	880
Glen	970	960	890	880
Hilton	955	955	865	820
Jesmond & Roma	970	960	890	880
Majestic	960	960	825	880
Oxford	970	960	880	870
Washington	970	960	890	880

FITTER FRIENDLY CASTINGS

The Integra can be housed comfortably inside a standard 76mm-rebated mantel. This alleviates the need for an installer to build a false chimney breast, use a deep rebated mantel or to knock a hole into the wall to accommodate the casting. In addition, the gas fire engine can be serviced or even replaced simply by removing the inner fascia.

Mantel	E Shelf Length	F Height	G Int Width	H Int Height	I Base	J Shelf Width	K Rebate
Athena	1525	1150	965/815	915	Variable	250	76
Balmoral	1375	1135	915	915	1240	215	25/76
Corinth	1370	1130	915	920	1230	210	25/76
Danbury	1372	1225	915	915	1200	200	25/76
Durham	1520	1140	940/790	915	Variable	300	76
Flat Victorian	1470	1150	965/865	915	Variable	205	76
Grizedale	1370	1135	900	900	1215	195	25/76
Keilder	1365	1220	915	915	1225	230	25/76
Limerick	1530	1200	915	915	1400	220	76
Lindisfarne	1345	1120	915	915	1250	250	25/90
Richmond	1475	1145	915	915	1330	240	25/76
Rothbury	1370	1135	915	915	1230	210	25/76
Verona	1510	1150	940/790	915	Variable	250	76
York	1370	1140	860/970	915	Variable	195	76

Hand Painted Tubeline Tiles

Tubeline Tiles were traditionally made to withstand the high temperatures generated by a working fireplace and performed the practical function of reflecting heat into the room when placed at an angle facing inward.

With a choice of five designs and various colour options, two runs of five tiles make up a set to fit into an Integra casting. The Luscia and Mediterranean Poppy tile sets include a left and right handed design. Our tubeline tiles are individually handpainted in the traditional way and will be subject to colour variation and normal crazing.

Liberty



Brown Yellow Ivory Blue Green Burgundy Honey Yellow Ivory Burgundy

Oriental Iris

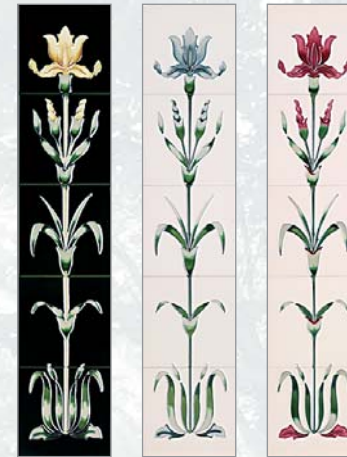

Green Yellow Ivory Blue Ivory Burgundy

Luscia



Honey Yellow Ivory Blue Ivory Burgundy

Mediterranean Poppy



Honey Yellow Ivory Burgundy Green Burgundy Ivory Blue

Tulip

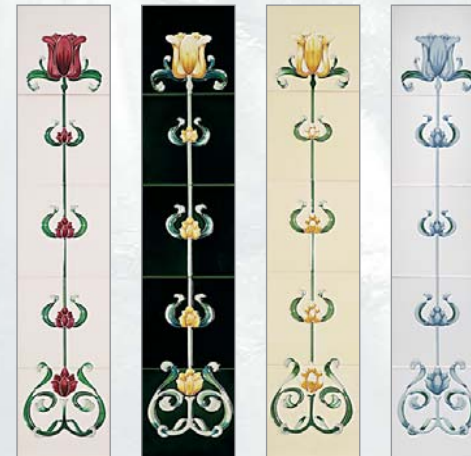

Ivory Burgundy Green Yellow Honey Yellow Ivory Blue

Cast-Iron Sleeves



Lily Man and Woman Victorian Urn



Med Poppy Tulip Bird Daisy

Accessories Matt black cast-iron paint, grate polish (antique finish) or metal polish (Duracote Finish) can be applied to your cast-iron fireplace but only in exceptional circumstances following expert advice and by using the utmost care.



Grate polish, metal polish & matt black paint

Cast-iron sleeves are an alternative to the more colourful tubeline tiles. Two sleeves make up a set to suit an Integra casting. The Bird sleeves and Man & Woman sleeves include a left and right handed design. Cast-iron sleeves are available in matt black, antique or highlight polished finishes.

Gas Fires with Trims & Frets

Multiflue

The Classic Multiflue is a simple yet effective coal effect fire (with pebble or driftwood options) being designed to fit almost any chimney or flue-type. Its cosy flame picture and 3.3kW output make it a welcome edition to any living room.

Shown here with a chrome trim and Media fret in black & chrome, the Classic Multiflue is also available in a brass or black finish with a choice of fret.

The Traditions solid oak Grizedale mantel in a period finish looks elegant against the contrast of the black granite hearth set and chrome embellishments of the gas fire.

Mantel	Grizedale Oak
Back panel	Granite 37" x 37"
Hearth	Granite 54" x 15"
Trim	Chrome
Fret	Media – Black & Chrome
Gas	Classic Multiflue



Gas Fires with Trims & Frets

Convector

The Integra Convector stands alone in the convector market with its impressive 4kW output delivering the warmth and efficiency you would expect. Suitable for traditional chimneys with its extra depth the Integra Convector has an impressive flame picture and is available in either a manual or hand held remote control.

Shown here with a black trim and Bauhaus fret in black, the Integra Convector is also available in a brass or chrome finish with a choice of fret.

The Traditions solid oak Rothbury mantel in a period finish gives a rather minimalist and understated look when combined with the highly polished cast-iron of the Hilton fascia shown here in a Half Polish finish. The Hilton fascia is also available in a Full Polish, Matt Black or Polished moulding only version.

Cast	Hilton Half Polish
Mantel	Rothbury Oak
Hearth	Granite 54" x 15"
Trim	Black
Fret	Bauhaus - Black
Gas	Integra Convector

Gas Fires with Trims & Frets

Powerflue

The Integra Powerflue has been designed specifically for homes without a chimney or flue. A fan operated flue system allows the 3.3kW output gas fire with its realistic flame picture to be fitted to a suitable external wall.

Shown here with a brass trim and brass New Wave fret, the Integra Powerflue is also available in a chrome or black finish with a choice of fret.

The Traditions solid oak Corinth mantel in a period finish has a splendid curved inner moulding complementing the unusual curve of the black granite hearth.

Mantel	Corinth Oak
Back panel	Granite 37" x 37"
Hearth	54" x 15" Half Moon
Trim	Brass
Fret	New Wave - Brass
Gas	Integra Powerflue



Frets & Trims



Bauhaus

-  Black
-  Brass
-  Chrome (as shown)



Media

-  Black & Chrome
-  Black & Brass (as shown)



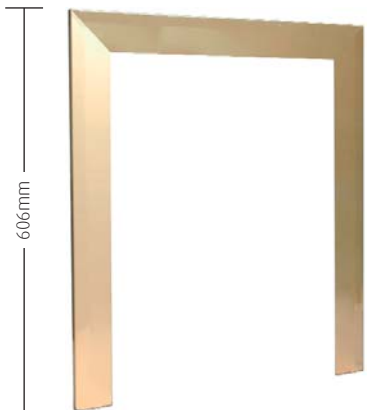

New Wave

-  Black (as shown)
-  Brass
-  Chrome



Trim

-  Black
-  Brass (as shown)
-  Chrome

606mm

513mm

Gas Fire Specifications

Classic Multiflue

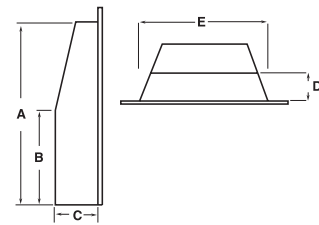

Dimensions	Input High	6.5kW
A 550mm	Output High	3.3kW
B 302mm	Air vent required	No
C 120mm		
D 70mm		
E 329mm		



Integra Convector

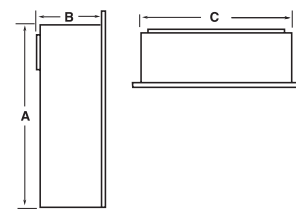

Dimensions	Input High	6.9kW
A 550mm	Output High	4.0kW
B 250mm	Air vent required	No
C 400mm		



Integra Powerflue

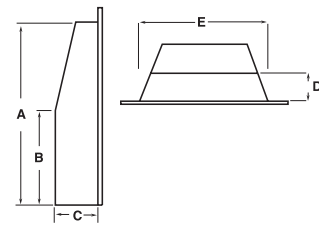

Dimensions	Input High	6.5kW
A 550mm	Output High	3.3kW
B 457mm	Air vent required	No
C 105mm		
D 90mm		
E 325mm		

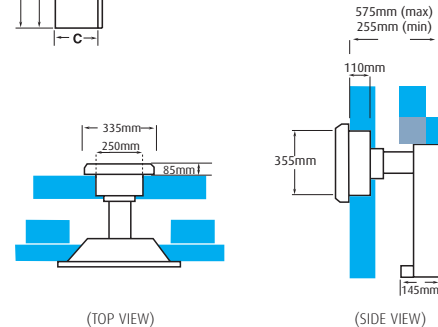

Powerflue Housing

Cast Iron Care

Packaging

Your Integra cast-iron fireplace is packaged so as to minimise exposure to adverse elements and should reach you in perfect condition. The product should be stored in a warm, dry environment and remain packaged until the fireplace is ready to be installed. This will prevent accidental damage being caused, which will not be covered under warranty. It is essential that you inspect your Integra casting prior to installation as it will be deemed to be of merchantable quality thereafter and no liability will be accepted for product removal, reinstallation or redecoration.

Cleaning

Your Integra casting requires only the minimum upkeep and it should remain in superb condition for many years. Matt black, antique or Duracote finishes can be maintained simply by dusting with a dedicated dry paint brush.

Warning

Cast-iron products are vulnerable to rust and tarnishing if exposed to dampness or water. Avoid the use of damp cloths, water-based liquids, furniture polish, detergents, oils, grease etc. onto the surface of the cast-iron. Should your fireplace become wet for any reason, dab it gently with a simple dry cloth. This should prevent any tarnishing or rust from forming. It is normal for some discoloration to occur to the working parts of a cast-iron fireplace.

Important Information

Products shown in this brochure are manufactured for Cast Tec Ltd., who, with a professional group of companies, distribute them exclusively in the U.K.

Goods must be checked prior to installation, as no responsibility will be accepted thereafter for the redecoration, removal or reinstallation of products. Faulted goods must be reported within 48hours.

Installation should be carried out by a professional CORGI registered fireplace fitter. No responsibility will be accepted for damage or problems arising from an incorrect or unqualified installation.

Integra and Duracote are registered trademarks and the Integra Split Fascia Concept is patented.

Integra Engines are CE approved and manufactured specifically to suit the Integra Casting.

No responsibility will be accepted for problems arising where a gas appliance has been used which is not approved or suitable to fit into the Integra Casting or where the fitting has taken place without the relevant instructions.

Cast Tec Ltd., reserve the right to delay or withdraw products, change designs, specifications or materials without prior notice due to continuous product development or supply problems.

Photographs and designs shown in this brochure are the copyright and design rights of Cast Tec Ltd. and can only be used or copied with permission.



Produced by Irving Design for

CASTTEC

Photography by Colin Thompson